

Large Diameter – Wafer & Full Lug Cast Iron Butterfly Valve

SERIES – 2000 (150#)

Valves meet MSS SP-67 & API 609

Flange drilling to: ANSI B16.1 Class 125/150

Testing to: API 598

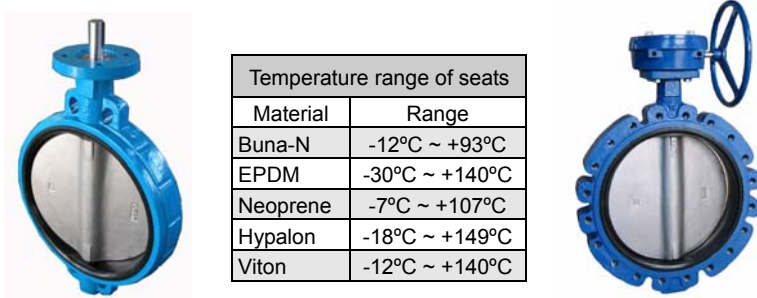

Temperature range of seats	
Material	Range
Buna-N	-12°C ~ +93°C
EPDM	-30°C ~ +140°C
Neoprene	-7°C ~ +107°C
Hypalon	-18°C ~ +149°C
Viton	-12°C ~ +140°C

Materials:

No.	Part Name	Specification
1	Screw	Carbon steel
2	Bottom cover	Ductile iron
3	O-Ring	Buna-N
4	Lower bushing	PTFE
5	Body	Ductile iron
6	Stem	410SS
7	Disc	Nickel plated Ductile iron
8	Taper pin	Carbon steel
9	Seat cartridge	Buna-N w/ phenolic backing ring
10	Mid bushing	PTFE
11	Nameplate	Carbon steel
12	Upper bushing	PTFE
13	O-Ring	Buna-N
14	Key	Carbon steel

Test Pressures	Shell: 225 psi
	Seat: 165 psi

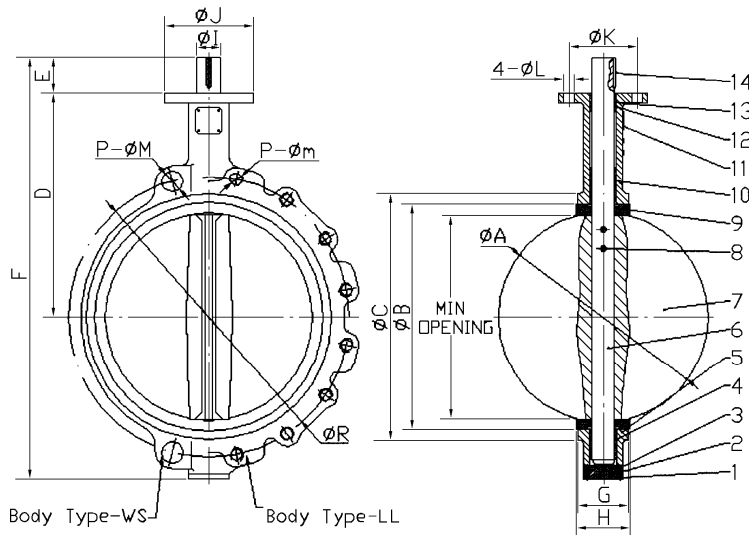

Body Type-WS Body Type-LL

Options:

- **Disc:** Nickel plated ductile iron, Aluminum bronze, 304SS, 316SS, WCB, Nylon coated DI, PTFE coated DI.
- **Body:** Cast iron, Ductile iron, WCB, 304SS, 316SS, Aluminum bronze.
- **Seat:** Buna-N, EPDM, Viton, PTFE, Hypalon, Neoprene.
- **Stem:** 416SS, 431SS, 410SS, 316SS.

Note:

- All seats are a cartridge style with the "rubber" bonded to a phenolic backing ring for support.
- Please refer to the Numbering System guide, 2000 series, to establish a figure number for ordering.
- Seat materials are capable of withstanding lower temperatures without damage. However, the elastomer becomes hard and torques increase. Some flow media may further restrict the published temperature limits and/or significantly reduce seat life.

Dimensions:

Size		A		Min		B		C		D		E		F		G		H	
in	mm	in	mm	in	mm	in	mm	in	mm	in	mm	in	mm	in	mm	in	mm	in	mm
14	350	13.1	333.3	12.7	322.0	14.8	375.1	15.9	405	14.5	368	1.77	45	26.8	680.0	3.01	76.5	3.13	79.5
16	400	15.3	389.6	14.9	379.1	17.3	439.5	18.5	470	15.7	400	2.83	72	30.7	780.6	3.37	85.7	3.54	90
18	450	17.3	440.5	16.8	426.8	19.3	490.5	20.5	521	16.6	422	2.83	72	32.3	821.6	4.12	104.6	4.29	109
20	500	19.5	491.6	18.6	472.7	21.1	535.4	22.2	565	18.9	480	3.23	82	36.1	916.0	5.13	130.3	5.31	135
24	600	23.3	592.5	22.5	571.6	25.7	654.0	27.3	693	22.1	562	3.23	82	43.4	1102.7	5.96	151.4	6.14	156
30	750	27.7	703.6	28.2	716.3	31.1	789.9	34.1	866	25.5	648	2.60	66	51.8	1315.7	6.59	167.4	6.77	172

Size		ØI		ØJ		ØK		ØL		P	P-m	P-M	R		Weight LL		Weight WS		
in	mm	in	mm	in	mm	in	mm	in	mm	in	mm	in	in	in	mm	lb	kg	lb	kg
14	350	1.24	31.6	5.51	140	4.02	102	4-.47	12	.63	16	1"	1 1/8"	18.1	460	123	56.0	91	41.3
16	400	1.50	38.0	7.76	197	5.51	140	4-.71	18	.63	16	1"	1 1/8"	20.3	515	215	97.7	139	63.0
18	450	1.69	42.9	7.76	197	5.51	140	4-.71	18	.79	20	1 1/8"	1 1/4"	22.2	565	272	123.8	178	80.7
20	500	1.80	45.7	7.76	197	5.51	140	4-.71	18	.79	20	1 1/8"	1 1/4"	24.4	620	448	203.7	286	129.8
24	600	2.13	54.0	10.87	276	6.50	165	4-.87	22	.79	20	1 1/4"	1 3/8"	28.5	725	602	273.5	422	191.6
30	750			11.81	300	10	254	8-.71	18	.79	20	1 1/4"	1 3/8"	36.0	914	814	370	760	345.5